

Selectaglaze secondary windows are designed to present a clean appearance on the room side. All units are purpose made to suit a particular window opening and so ensure the highest performance. The odd leg frame system allows tolerances to be accommodated without applying face cover fillets. In almost all circumstances fixings are concealed within the framework. When larger section timber frames or cill extensions are required these are finish decorated on exposed room side surfaces. Typical fixing details are illustrated

S1

## Standard Square Reveal Fix

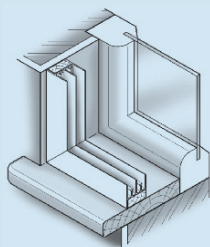

- 33mm x 15mm twice primed softwood ground bedded on acrylic mastic and fixed to structure
- Odd leg frame with applied mastic lips ground and is fixed to it
- Local concealed packers take up opening tolerance
- Optional caulking point between frame and wall allows finished decoration

### Guidance

- Set back minimum 12mm from wall face to avoid blowing plasterwork
- Any hinge fixings must penetrate into structure
- Enlarged timber grounds required when:
  - dealing with very irregular openings
  - providing access to remote blind controls
- Optional back fillet available to conceal packing

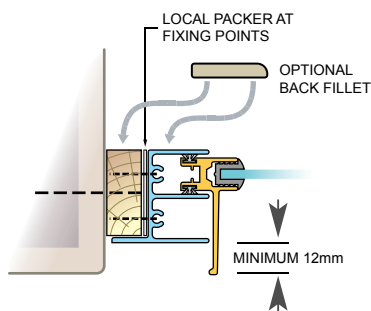

S3

## Face Fix

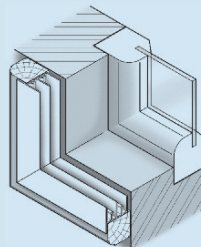

- Softwood frame with minimum 38mm x 32mm section bedded on acrylic mastic and fixed back to structure
- Optional ovolo moulding
- Aluminium frame fixing continues as S1

### Guidance

- Suitable detail where:
  - no reveal exists
  - clearance is needed for inward opening windows
- Remote blind controls and ventilators cannot normally be accommodated

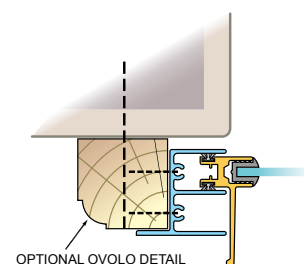

S4

## Inset Box Sash

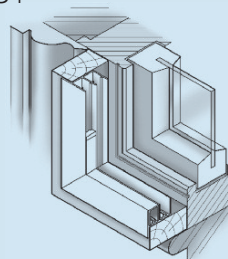

- Timber sized to provide a minimum 75mm glass to glass cavity and fixed back to box sash
- Optional ovolo moulding
- Aluminium frame fixing continues as S1

### Guidance

- Minimum 75mm cavity applies to use of matching sash window, normally Series 20
- Existing architraves will sometimes need to be resited both for practical and visual reasons

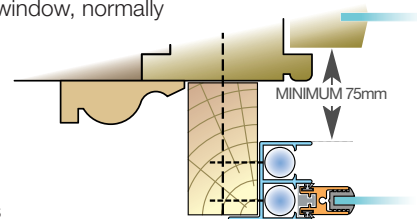

S2

## Splayed Reveal Fix

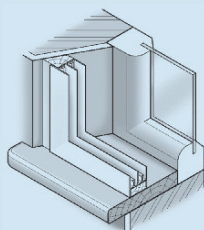

- Shaped softwood ground is machined to match the splay
- Aluminium frame fixing continues as S1

### Guidance

- When attaching to shutters, ensure that these are securely fixed back and sealed
- Timber section can be sized to accommodate remote blind controls
- 12mm minimum setback as S1

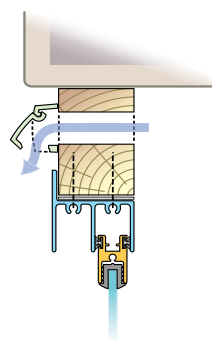
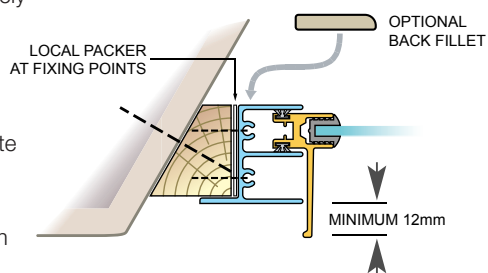

### Ventilators

- Accommodated through enlarged timber section generally at head of window